

JUNO 5



The **Juno** is a versatile stove, simple in design, allowing it to suit most styles of décor.

The stove boasts a very **wide screen** on the door allowing for a maximum viewing area.

A multi-fuel grate enables the burning of seasoned **wood** and **smokeless fuels**.

The Juno also benefits from triple burn technology consisting of **Primary Air Burn** (control on door), **Airwash Secondary Burn** (lever above door) and **Tertiary Air** with inlets inside the rear of the stove (this system mixes pre-heated air with exhaust gases allowing the exhaust gas to re-ignite producing a cleaner and more efficient stove).

Victorian Package Option:

*Flat Victorian Mantel in Turkish Limestone
Shelf length 1500mm (59") or 1350mm (53")
Heat Resistant Vermiculite Boards
Honed Black Granite Hearth 1450mm (57")
or 1350mm (51") with inset and slip set.*

Key Facts:

Nominal Heat Output	5.0kW
Construction	Steel & Cast-Iron
Weight	74Kg
Flue Outlet	Top or Rear (125mm)
Efficiency Wood	79%
Efficiency Smokeless Fuel	74%
Air Vent Required	No (but refer to manual)

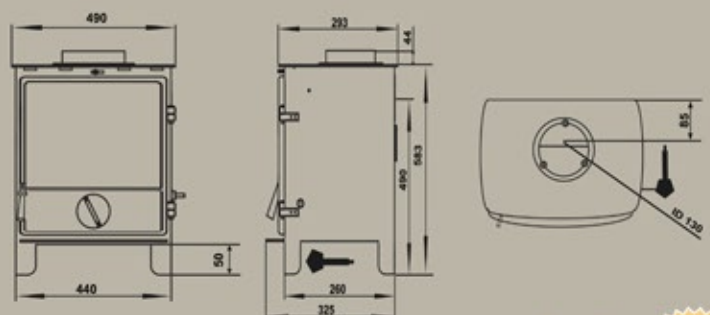

DEFRA
exempt